

# APEX GRAND VIEW MANGADU



## APEX CONSTRUCTIONS Builder & Promoter

Office: Raj Palace, 55, Thiruvalluvar St., Postal Audit Colony, Saligramam, Chennai - 93  
E-mail: [apexconstruction97@gmail.com](mailto:apexconstruction97@gmail.com) | [www.apexconstructions.co](http://www.apexconstructions.co) | M: **96776 7777**



**APEX CONSTRUCTIONS**  
Builder & Promoter

Site Address:

**Plot No.1**  
**Manali Saravanan Nagar**  
**Mangadu**  
**Chennai**

Office:

**Raj Palace**  
55, Thiruvalluvar St.,  
Postal Audit Colony  
Saligramam  
Chennai - 600 093

apexconstruction97@gmail.com  
www.apexconstructions.co

**96776 77777**

**APEX GRAND VIEW**  
**STILT FLOOR PLAN**

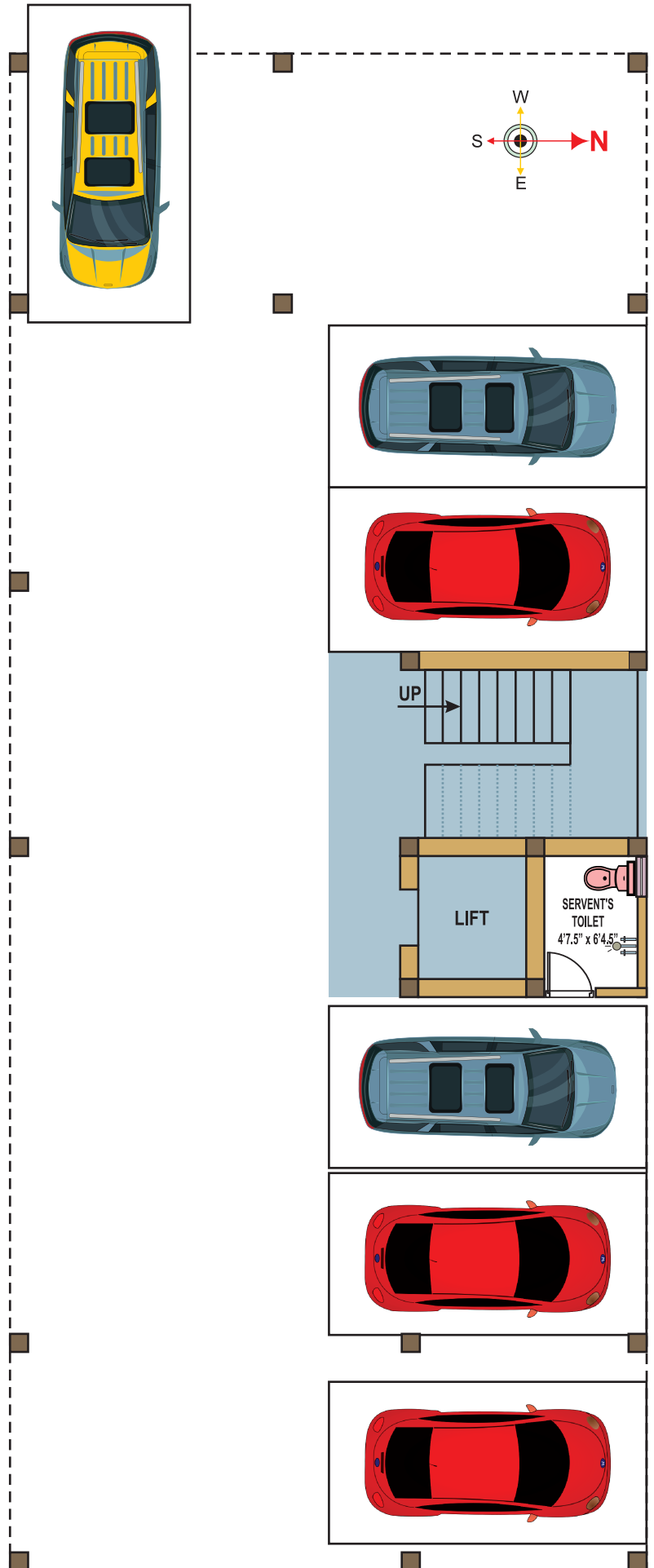



**APEX CONSTRUCTIONS**  
Builder & Promoter

Site Address:

**Plot No.1**  
**Manali Saravanan Nagar**  
**Mangadu**  
**Chennai**

Office:

**Raj Palace**  
55, Thiruvalluvar St.,  
Postal Audit Colony  
Saligramam  
Chennai - 600 093

apexconstruction97@gmail.com  
www.apexconstructions.co

**96776 77777**

**APEX GRAND VIEW**  
**TYPICAL FLOOR PLAN**

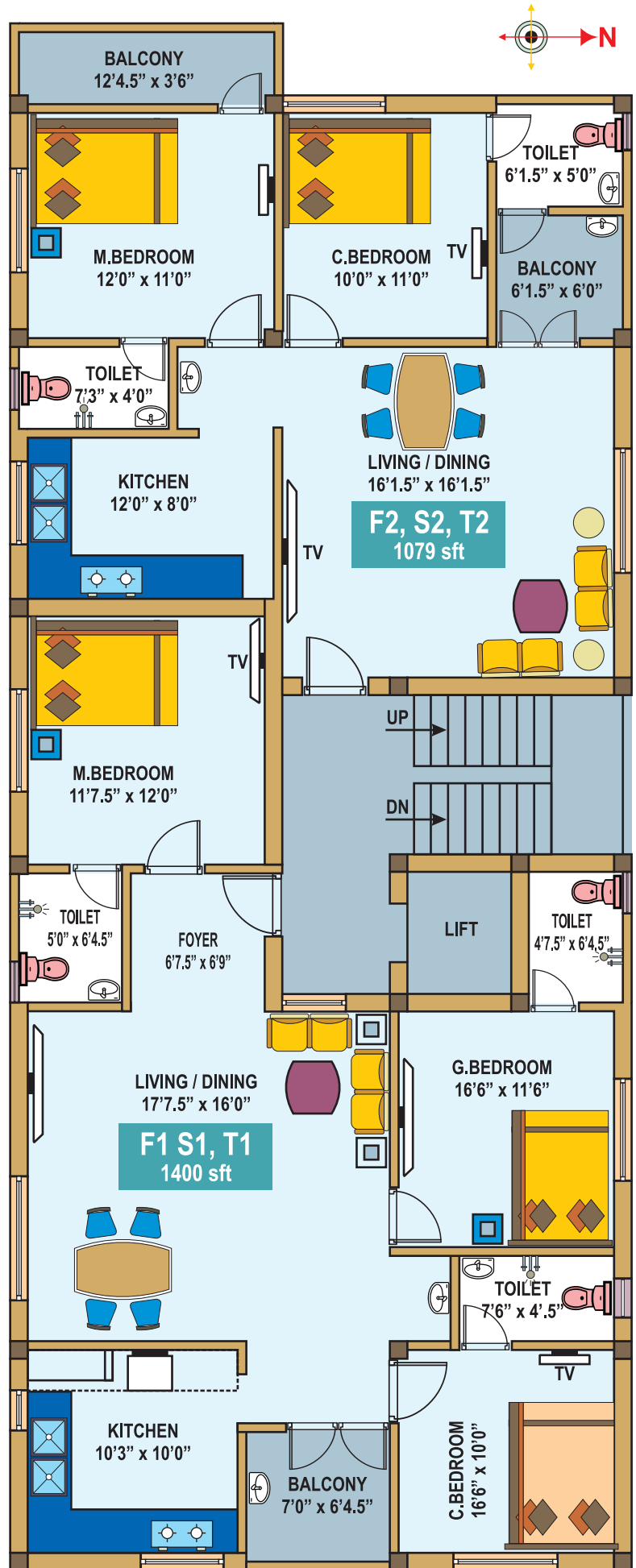

## Area

| First Floor   | Second Floor  | Third Floor   |
|---------------|---------------|---------------|
| F1 - 1400 sft | S1 - 1400 sft | T1 - 1400 sft |
| F2 - 1079 sft | S2 - 1079 sft | T2 - 1079 sft |

## Features

1. Automatic Lift
2. Bio Septic Tank
3. Covered Car Park
4. Automatic Water Control
5. Invertor Provision
6. Modular Switches
7. Parryware Plumbing and Sanitary Fittings
8. Hall Area False Ceiling with lights
9. Vitrified Tiles 4 feet x 2 feet
10. Common Toilet in Ground Floor
12. Aesthetic Elevation
13. Emulsion paint for Interior and Exterior Wall
14. Rain Water Harvesting
15. Bore and Sump Water Tank



**APEX CONSTRUCTIONS**  
Builder & Promoter

**APEX – GRAND VIEW**